

SURVEYOR'S OFFICE
Hamilton County

Kenton C. Ward, Surveyor

One Hamilton County Square, Ste. 146

776-9626 776-8495

942 Maple Avenue

Noblesville, Indiana 46060 July 8, 1992

TO: Hamilton County Drainage Board

RE: O.F. Henley Drain-Carmel West Elementary School ^{now}

Smoky Run

Attached is a petition, non-enforcement request, plans and schedule of assessments as submitted by the Carmel Clay School Board for the Carmel West Elementary School Arm of the O.F. Henley Drain. The schedule of assessments shows the name and address of each owner, the legal description, parcel number as shown by the tax duplicate or record of transfers by the County Auditor wherein the land is situated, which lands, in my opinion, will be affected by the proposed improvement and the public roads or highway owned by the County or by the State of Indiana by name or number and the Right of Ways of railroads by section, township and range.

I have reviewed the submittals and petition which was referred to me on June 18, 1992 and have found each to be in proper form. I have made a personal inspection of the land described in the petition. Upon doing so, I believe that the drain is practicable; will improve the public health; benefit a public highway and be of public utility; and that the costs, damages and expenses of the proposed drain will probably be less than the benefits accruing to the owners of land likely to be benefitted.

The drain consists of the following of 1341 feet of 24" RCP, which was constructed by the School Board as the offsite storm sewer for the Carmel West Elementary School. The location of the drainage facility is shown on the attached plan. The storm sewer is proposed to be part of the O.F. Henley Drain as the Carmel West Elementary Arm of the drain.

The maintenance work required for the said tile drain includes the repairing of tile, structures, maintaining the outlet

and any other work necessary which will keep the tile in proper working order as and when needed.

I recommend a maintenance assessment remain as is for the per acre assessment and increase the current \$3.00 minimum to a \$5.00 minimum.

I recommend a hearing be set for September 1992. I also recommend the Board approve the attached non-enforcement request at that time.

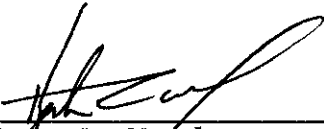

Kenton C. Ward
Hamilton County Surveyor

KCW/no

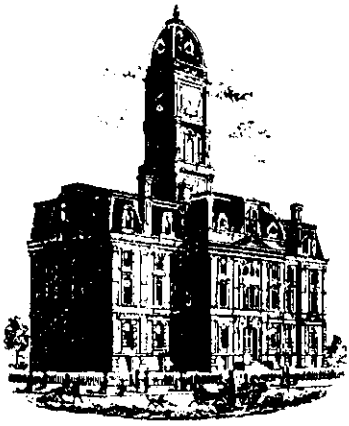

SURVEYOR'S OFFICE
Hamilton County

Kenton C. Ward, Surveyor

Phone (317) 776-8495

Fax (317) 776-9628

Suite 146

One Hamilton County Square

Noblesville, Indiana 46060-2230

To: Hamilton County Drainage Board

October 6, 1997

Re: O. F. Henley Drain: Carmel West Elementary

Attached are as-builts, certificate of completion & compliance, and other information for the Carmel West Elementary Arm to the O. F. Henley Drain. An inspection of the drainage facilities for this section has been made and the facilities were found to be complete and acceptable.

During construction, there were no significant changes made to the drainage plans submitted with my report for this drain dated July 8, 1992.

Therefore, the length of the drain remains at **1,341 feet**.

The non-enforcement was approved by the Board at its meeting on September 21, 1992 and recorded under instrument #9237250.

The bond or letter of credit was not required.

I recommend the Board approve the drains construction as complete and acceptable.

Sincerely,

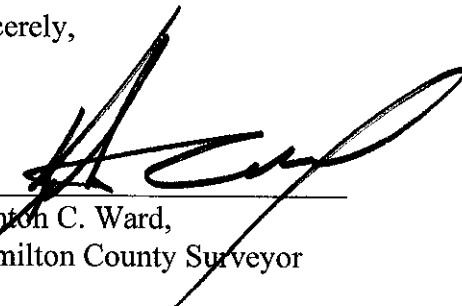

Kenton C. Ward,
Hamilton County Surveyor

KCW/slm

Asbuilt Structures

Project: OF HENLEY - Carmel West Elem. Area

Structure: T.C.: I.E.: Pipe: Length: Original Plans: Difference:

| | | | | | | |
|----|--------|--------|-----|------|----------|----|
| 6 | 887.99 | 874.70 | | | | |
| 5A | 887.78 | 874.40 | 24" | 52' | | |
| 5A | 887.78 | 874.35 | | | | |
| 5 | 886.87 | 873.43 | 24" | 185' | | |
| 5 | 886.87 | 873.33 | | | | |
| 4 | 884.35 | 872.24 | 24" | 235' | FRM 343' | -8 |
| 4 | 884.35 | 872.14 | | | | |
| 3 | 874.18 | 869.38 | 24" | 394' | FRM 392' | +2 |
| 3 | 874.18 | 869.28 | | | | |
| 2 | 874.13 | 868.86 | 24" | 89' | FRM 87' | +2 |
| 2 | 874.13 | 868.76 | | | | |
| 1 | 874.77 | 867.66 | 24" | 236' | FRM 237' | -1 |
| 1 | 874.77 | 867.56 | | | | |
| ES | - | 866.79 | 24" | 150' | FRM 155' | -5 |
| | | | | | | |
| | | | | | | |
| | | | | | | |
| | | | | | | |

6" SSD Streets:

| | |
|--|--|
| | |
| | |
| | |
| | |
| | |
| | |
| | |
| | |

Total: _____

6" SSD Lots:

| | |
|--|--|
| | |
| | |
| | |
| | |
| | |
| | |
| | |
| | |

Total: _____

RCP Pipe Totals:

| | |
|-----|-------|
| 24" | 1341' |
| | |
| | |
| | |
| | |
| | |
| | |

| | |
|--|--|
| | |
| | |
| | |
| | |
| | |
| | |
| | |

Other Drain:

Total Length of Drain:

1341'

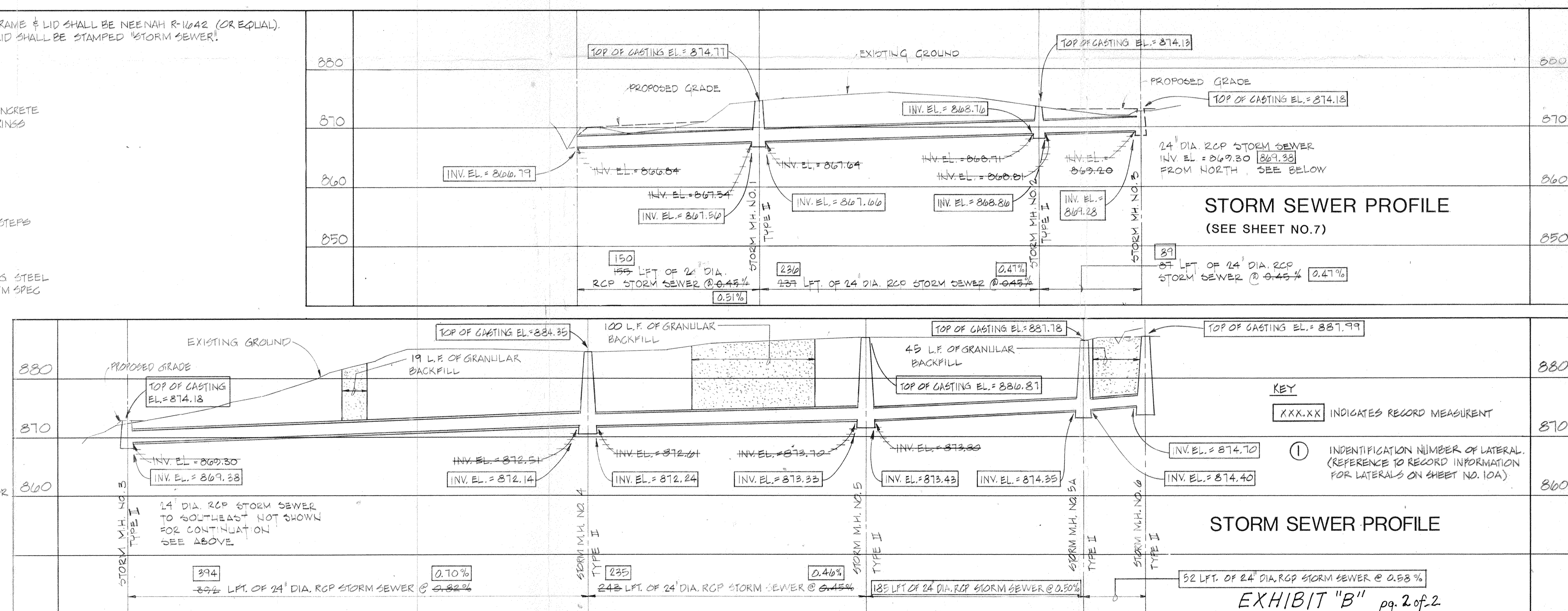
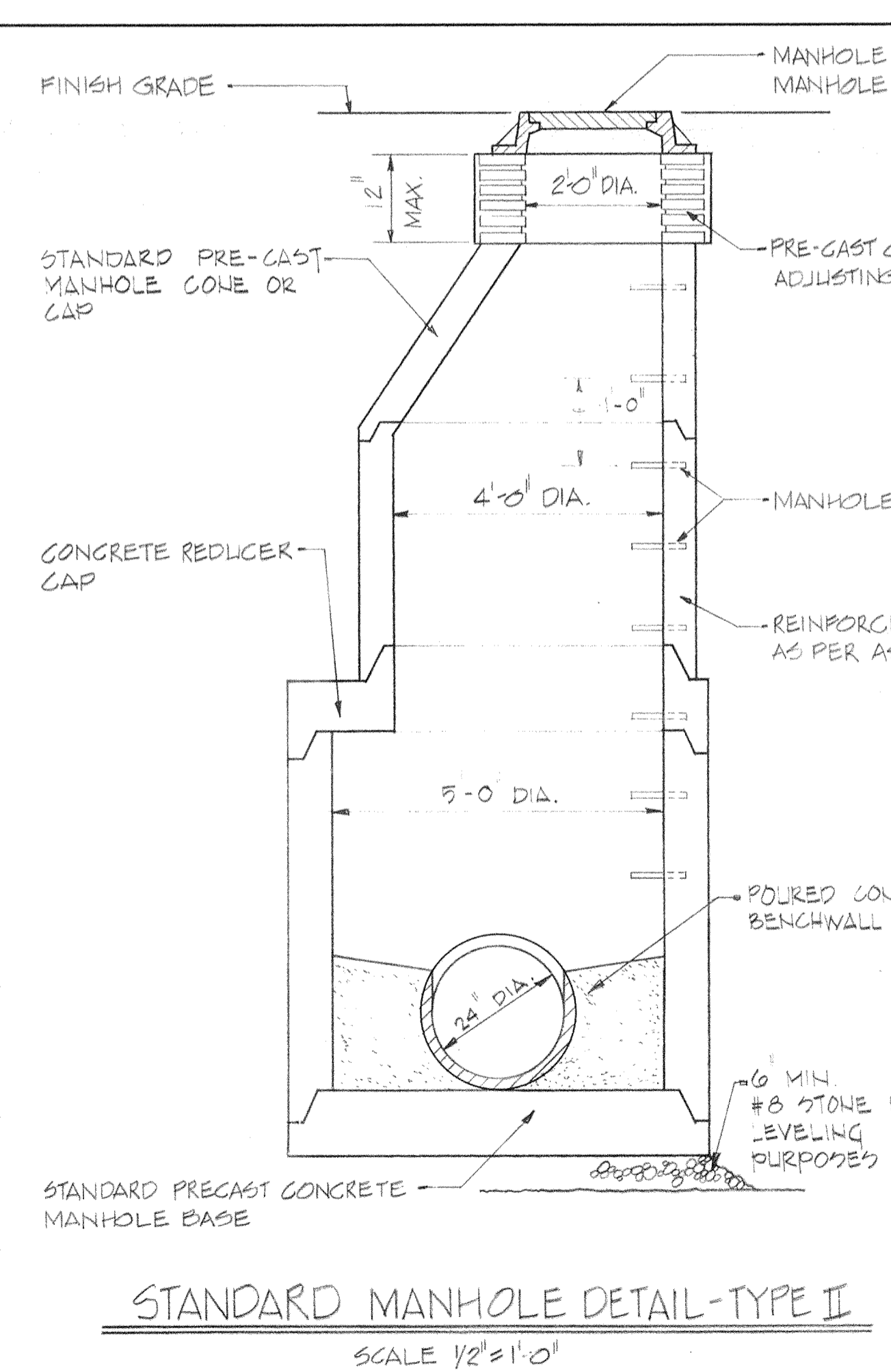
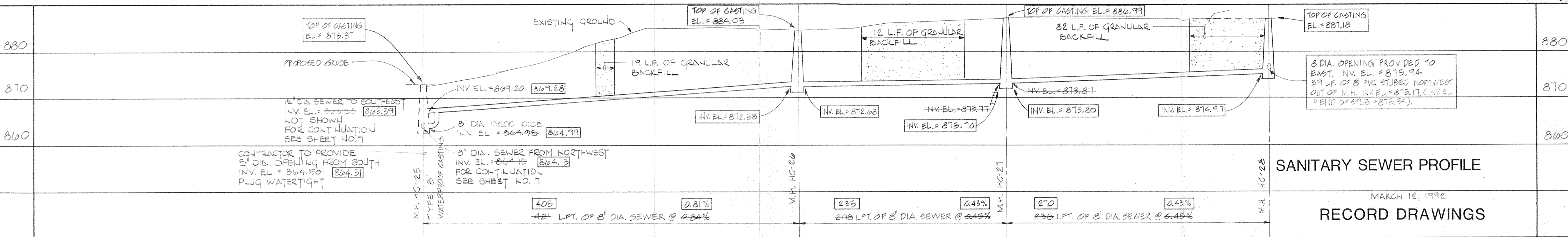
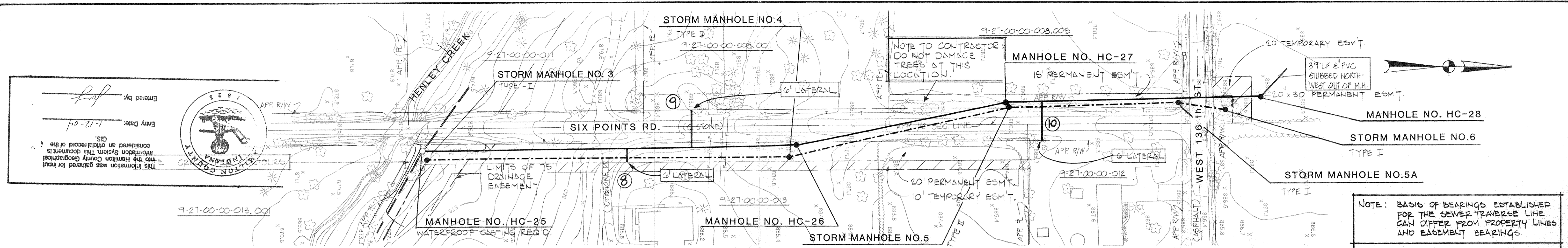

| SYMBOL | REVISIONS | BY | DATE | APPROVED | DESIGNER | Q. ANDRICK | JOB NO. | CTRWD | SHEET NO. |
|--------|--|-----|---------|----------|-------------|-------------|---------|-------------------|-----------|
| | REALIGNED SANITARY SEWER, ADDED STORM SEWER & HEADWALL | JDT | 2-14-91 | RLL | DRAFTING | Q. ANDRICK | 1184 | HENLEY CREEK | 8 |
| | DELETED HEADWALL & REDUCE STORM SEWER PIPE SIZE | PD | 5-16-91 | RLL | PROJ. ENGR. | R. LUNDTSEN | | INTERCEPTOR SEWER | |
| | ADDED STORM SEWER EXTENSION PROFILE | PS | 7/29/91 | RLL | PROJ. MGR. | S.L. MADRE | | | |
| | REVISED D20" PIPE SIZE & INV. EL. @ M.H. HC-25 | PS | 7/29/91 | RLL | | | | | |

SCALE: 1" = 50'
CONTOUR INTERVAL 1'
DATE OF PHOTOGRAPHY

DATE: OCT. 1990

DATE: Nov. 13, 1990

6363 HOLLISTER DRIVE SPEEDWAY, INDIANA 46224

PLA N AND PROFILE

OF 10